

Sistema de cubierta

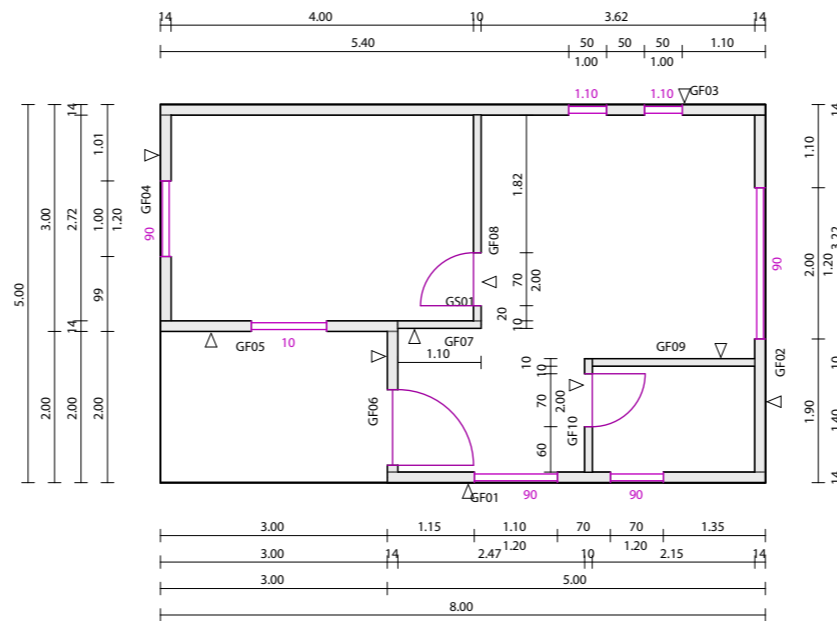

Vista en planta

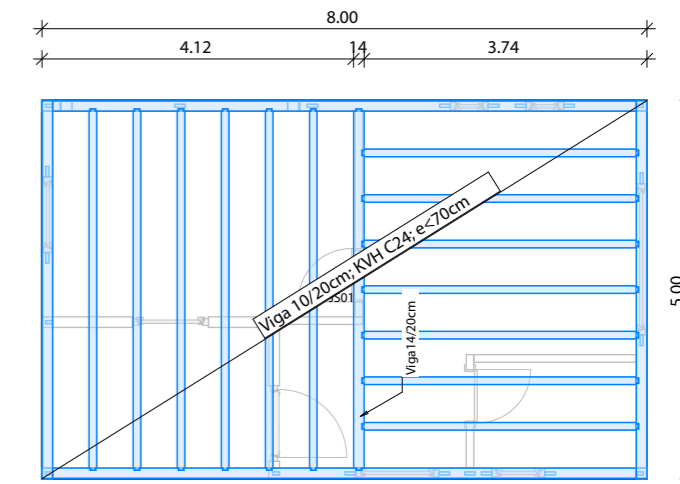

Sistema de envigado

Componente Dimensiones

- Anch. cabio 8
- Alt. Cabio 18
- 1. áng. canal 90.00
- L 1er. corte 12⁶
- 2. áng. canal 40.00
- L 2do. corte 8⁴
- AltSM (v) 19⁶
- AltSM (o) 15
- Prof. muesca 3
- Encintado ca. 32
- Dist. list. cumb 4
- longitud útil 0,3400
- Nb rangos 13

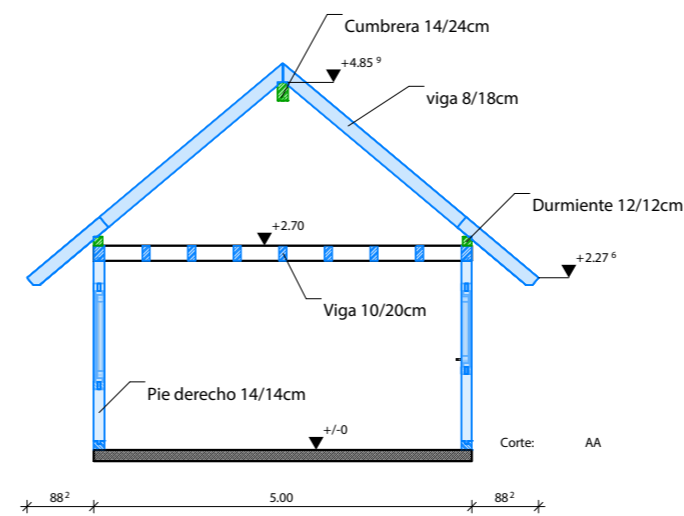
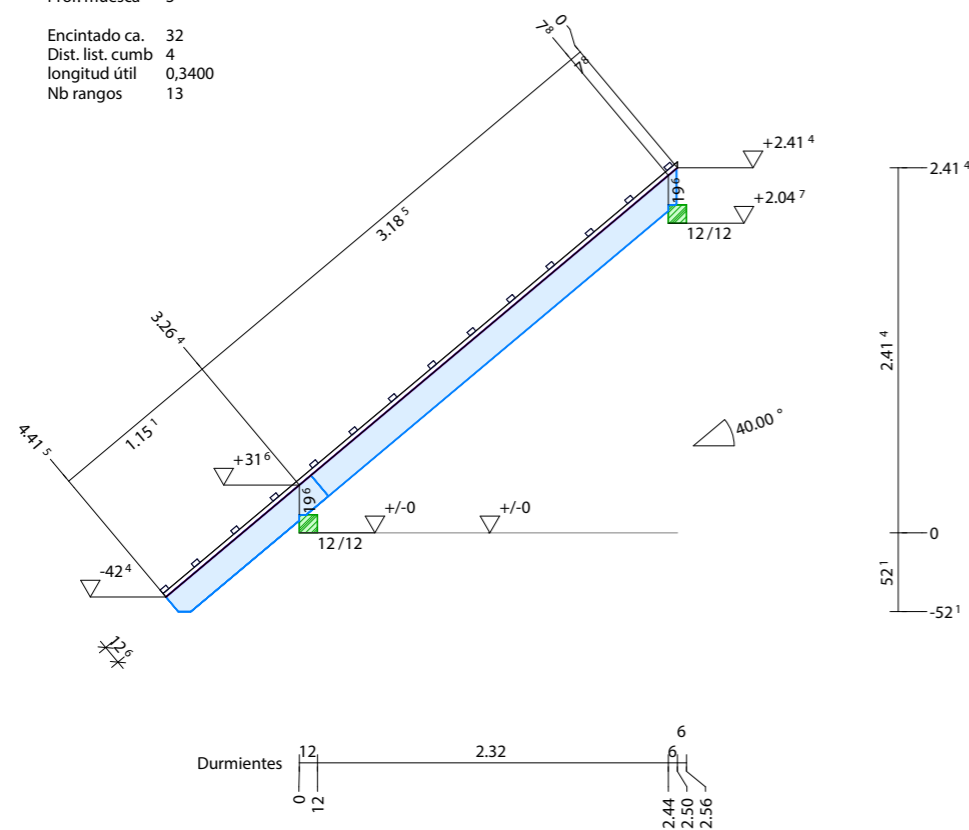

Corte A-A

SEMA GmbH

Salzstraße 25
87499 Wildpoldsried
Phone: +49 8304-939-0
E-Mail: sema@sema-soft.de



Componente : Curso para principiantes

24.01.2022

BP : Casa de vacaciones
Town :
Customer:
Editor :

S : 1 : 100